



HILLSDALE COUNTY DRAIN COMMISSIONER
Matt Word
33 McCollum Street
Hillsdale, Michigan 49242

O’HARROW INTERCOUNTY DRAIN #181

NOTICE OF DAY OF REVIEW OF DRAINAGE DISTRICT BOUNDARIES AND REVIEW OF APPORTIONMENTS

DATE: Tuesday, August 27, 2024
TIME: 9:00 a.m. to 5:00 p.m.
LOCATION: Hillsdale County Extension Office
20 Care Dr. Suite B
Hillsdale, MI 49242
QUESTIONS: (517) 437-4181

The Hillsdale County Drain Commissioner will hold a Day of Review of Drainage District Boundaries and Apportionments on the above date, time, and location. The Day of Review is an opportunity to review the O’Harrow Intercounty Drain #181 Drainage District boundaries and the tentative apportionment of benefits for each parcel and municipality within the Drainage District with the Drain Commissioner or staff member. A map of the proposed Drainage District boundary revisions can be found enclosed with this notice and on the Drain Commissioner’s website at: <https://www.co.hillsdale.mi.us/index.php/tm-public-notice>.

The following is a list of any county, township, city, or village to be assessed: Hillsdale County and Wheatland Township.

At the Day of Review:

- No appointment is necessary.
- The Drain Commissioner, engineers and/or other staff members will be available to assist individuals and make revisions where necessary.
- The computation of costs for the Drain will be available.

Persons with disabilities needing accommodations for effective participation in the Day of Review should contact the Drain Commissioner’s Office at the number noted above (voice) or through the Michigan Relay Center at 7-1-1 (TDD) at least 24 hours in advance of the Day of Review to request mobility, visual, hearing, or other assistance.

Comments

Comments on the apportionment of benefits may be submitted in writing or verbally at the Day of Review. Comments may also be submitted in writing before the date of the Day of Review to:

MAIL: Hillsdale County Drain Commissioner
33 McCollum Street
Hillsdale, MI 49242
EMAIL: e.friskney@co.hillsdale.mi.us

Comments submitted in advance must be received by the Drain Commissioner prior to the Day of Review to ensure consideration.

Assessments & Appeals

Drain assessments are collected in the same manner as property taxes and will appear on your winter tax bill. If drain assessments are being collected for more than one (1) year, you may pay the assessment in full with any interest to date at any time and avoid further interest charges.

You may appeal the Drain Commissioner's decision to revise the district boundary to the Hillsdale County Circuit Court within ten (10) days. You may appeal the Drain Commissioner's determination of apportionments to the Hillsdale County Probate Court within ten (10) days.

Matt Word
Hillsdale County Drain Commissioner

O'HARROW INTERCOUNTY DRAIN DRAINAGE DISTRICT

MICHIGAN DEPARTMENT OF AGRICULTURE AND RURAL DEVELOPMENT - BRADY HARRINGTON, P.E.

HILLSDALE COUNTY DRAIN COMMISSIONER - MATT WORD

LENAWEE COUNTY DRAIN COMMISSIONER - JENNIFER ESCOTT

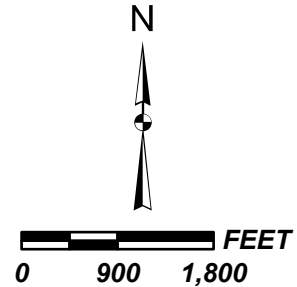
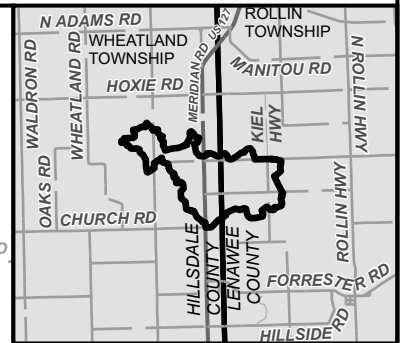
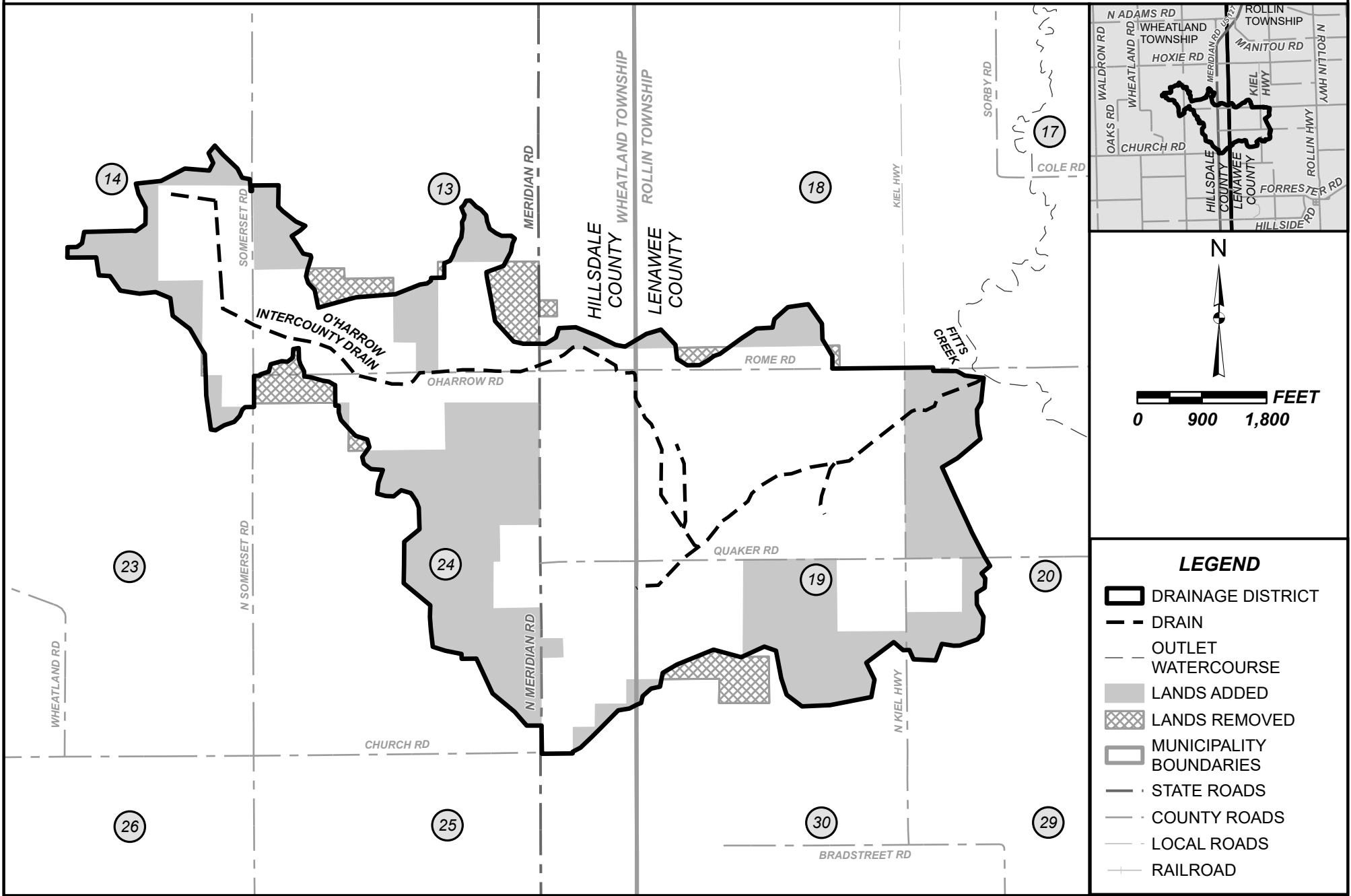

- LEGEND**
- DRAINAGE DISTRICT
 - DRAIN
 - OUTLET WATERCOURSE
 - LANDS ADDED
 - LANDS REMOVED
 - MUNICIPALITY BOUNDARIES
 - STATE ROADS
 - COUNTY ROADS
 - LOCAL ROADS
 - RAILROAD